

將軍澳百勝角第106區消防處
員佐級職員宿舍建造工程

The background is a solid blue color. On the right side, there are several white lines of varying thicknesses that originate from the top right corner and extend diagonally towards the bottom left, creating a sense of motion or a modern design element.

初步設計

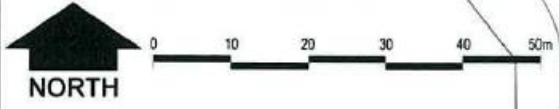

NO. OF CARPARK PROVIDED	101 (INCLUDING 3 ACCESSIBLE CAR PARKS)
NO. OF CARPARK FOR MOTOR CYCLE	7
NO. OF LOADING/UNLOADING PROVIDED	5
NO. OF TOWER	5
NO. OF STOREYS	TOWER A,B,D&E: 17, TOWER C: 18
NO. OF UNIT PROVIDED	548

LEGEND

- Application Site
- Children's Play Area
- Lawn
- Existing Slope <math>< 30^\circ</math>
- Planting Area
- Impact Absorbing Surface
- Sand Pitch
- Covered Walkway
- Drainage Reserved Area
- Accessible Car Parking Spaces
- Loading and Unloading Bay for Heavy Goods Vehicle
- Car Parking Spaces on Ground Floor
- Compensatory Trees with 5m Spacing on Ground Floor only (44 Trees)
- Compensatory Trees with 4m Spacing on Podium Floor only (16 Trees)
- Compensatory Trees with 3m Spacing on Existing Slope only (66 Trees)

NOTES

Planting Area / Greening Area:
About 3,100m² (25% of the Site area)

Open Space Area:
About 2,310m² (for the projected 1,944 residents)

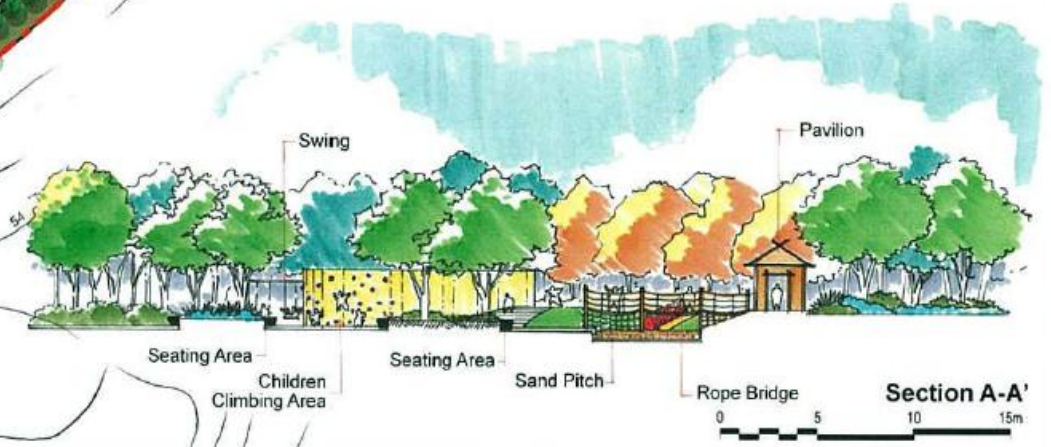

將軍澳

坑口

清水灣半島

消防及救護學院

是次宿舍項目



下洋山

是次宿舍項目

峻滢

日出康城

消防及救護學院

百勝角路



將軍澳百勝角第 106 區消防處員佐級職員宿舍建造工程
附近民居

